

JT25 Sales Sheet



Engine	Cummins QSB4.5
Horsepower	130 hp
Thrust	27,000 lb
Pullback	27,000 lb
Mud pump (FMC)	50 gpm
Length	231 in
Width	84.5 in
Weight	20,200 lb
Spindle torque (high speed)	2,600 ft-lb
Spindle torque (low speed)	4,000 ft-lb
Sound level	85 dBA

Proven Ditch Witch® Features

- **Dual pivot lift system** – allows for multiple entry angles while still keeping the tracks on the ground.
- **Dual rod guides** – same as JT30 and come standard with new urethane guide blocks. These are less expensive and last longer.
- **Angled open-top vise wrenches** – same as JT30 but rotated 180 degrees from JT30 orientation
- **Maintenance free front end** – We have no grease points (compared to 25 on the 24x40)
- **Anchors**
 - JT20 style anchor with larger drive motor and 40” ground engagement. (Vermeer® is 24”)
 - Optional JT30 style anchors with planetary drive motors and 38” ground engagement.
- **Pipe shuttle design similar to JT4020** – This is a proven design that allows us to decrease the overall height of the machine.
- **Magnetic proximity switches** – No moving parts. Vermeer uses rocker switches.
- **JT30 undercarriage and track assembly** – This is a proven and reliable undercarriage.
 - Uses new drive motors for smooth and balanced ground drive performance.
- **Tethered ground drive control** – Proven reliability. Also has manual override switches.
- **Independent rear stabilizers** – Drill frame and stabilizer controls on left side. Vermeer has one solid stabilizer.
- **Easy access fuel fill** – Competition’s fuel tank is at top of rack.
- **One unit controller** – Same V3 controller as JT30 and JT20



The Guts

- **130 HP Cummins QSB4.5 Tier 4i engine with 140 HP power bulge** (Proven JT30 engine with different software)
- **5 Pump System** – Thrust, Rotation, Load Sense and Double Gear Pump (Uses new H1 Thrust/Rotation pumps)
- **SAI Radial Piston Rotation Motor** – Low speed, High Torque. 10% more efficient with excellent low end breakout force and very smooth operation (quieter than JT30).
- **Dual Poclair Radial Piston Thrust Motors** – Low speed, high torque. No planetary needed. Large top rollers. 5 - 10% more efficient.
- **JT30 water swivel design** – Proven design
- **Single side, bolt on drill rack** – Single piece (not sections). Tested under load with equivalent to 5,000 hours
- **Abrasion resistant hoses and heavy hose track** – Highest rated, tested with drill rack.
- **Hydraulic Variable Speed Fan** – Same as JT30

Operator’s Station

- **New Operators station** – New Seat, angled control consoles, hydraulic platform swing, light kit.
- **Color LCD Engine Display** – Common with JT20 and JT30, located on left side of operator’s station.
- **Rocker Switches** – New marine grade switches common to JT20 and JT30.
- **New left side joystick** – Buttons on joystick for pipe loader operations. Shuttle, grip, lift, set, resume
 - **Pipe breakout** – Movement of joystick controls front and rear clamps for breakout (similar to JT20)

- **Strike display** – Located on left side of operator’s station
- **TD Display** – Located on right side of operator’s station.
- **Optional Cab** – 4020 style cab. Unit is same width with or without cab. Excellent visibility.



Carve Mode

- Roll to clock position of desired turn.
- Turn carve potentiometer to zero, then up ¼ turn for a starting point.
- Switch carve mode to ‘on’
- Thrust joystick forward and carve will begin
- Adjust potentiometer to increase or decrease carve ‘window’ (from 11-1 to 10-2 to 9-3 etc)
- To speed up or slow down thrust, hit ‘resume’ or ‘set’.
- To speed up or slow down rotation or carve speed, hold joystick towards leg and hit ‘resume’ or ‘set’.
- Hold ‘two speed’ button to override carve at any time and drill, when button released carve will resume at current clock position.

New Innovations

- **New SaverLok system** – Easy to change. No tools. No thread lock. Industry First. Uses drill wrenches.
- **Coordinated Make-up** – No float sensor
- **Pipe shuttles** – New row select indicator. New ‘add a pipe’ design (swivels up)
- **Excellent access to engine and pumps** – Metal side panels. Lift off side hoods. Electric hood lift for rear cover.

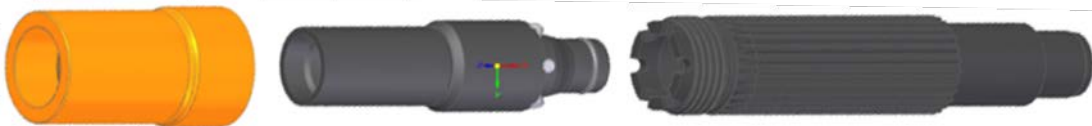

Options

- **Cab option** - as mentioned above
- **“Dual joystick” controls** – Thrust on right handed joystick, rotation on left handed joystick.
- **Ditch Witch JT30 Power Pipe** – Lined or unlined, 50 piece capacity
- **Single Piece Forged Pipe** – 55 piece capacity
- **JT30 style anchors** – as mentioned above. Adds 280 lbs to unit.